



Dryden Elementary School

722 S Dryden Place | Arlington Heights, IL 60005



AKEMI SESSLER, PRINCIPAL | YEAR OPENED: 1952 | CURRENT SQUARE FOOTAGE: 61,101

KINDERGARTEN	AGING BUILDING INFRASTRUCTURE	CAPACITY AND LEARNING ENVIRONMENTS
<ul style="list-style-type: none">(4) New classrooms	<ul style="list-style-type: none">Roof ReplacementsNew fire alarm system to replace obsolete and end of life systemCorridor, stage and misc. flooring replacements.Restroom finish upgradesNew energy efficient LED lighting and ceilings throughout	<ul style="list-style-type: none">Gym expansion to gain dedicated lunch and commons similar to all other D25 Elementary SchoolsMain office addition and renovations for improved security and visitor flow.Kindergarten addition gives building additional buffer space for current and future needs



Dryden Elementary School

722 S Dryden Place | Arlington Heights, IL 60005



PROPOSED KINDERGARTEN EXPANSION | (4) New Classrooms + Gym Expansion





Greenbrier Elementary School

2330 N. Verde Drive | Arlington Heights, IL 60004



DONNA BINGAMAN, PRINCIPAL | YEAR OPENED: 1964 | CURRENT SQUARE FOOTAGE: 66,585

KINDERGARTEN	AGING BUILDING INFRASTRUCTURE	CAPACITY AND LEARNING ENVIRONMENTS
<ul style="list-style-type: none">(2) New classrooms	<ul style="list-style-type: none">HVAC Boiler replacementsRoof replacementsTelecenter intercom replacement for daily and emergency communicationsFlooring replacements	<ul style="list-style-type: none">Gym air conditioning to meet District 25 standardKindergarten addition gives building additional buffer space for current and future needs



Greenbrier Elementary School

2330 N. Verde Drive | Arlington Heights, IL 60004



PROPOSED KINDERGARTEN EXPANSION | (2) New Classrooms

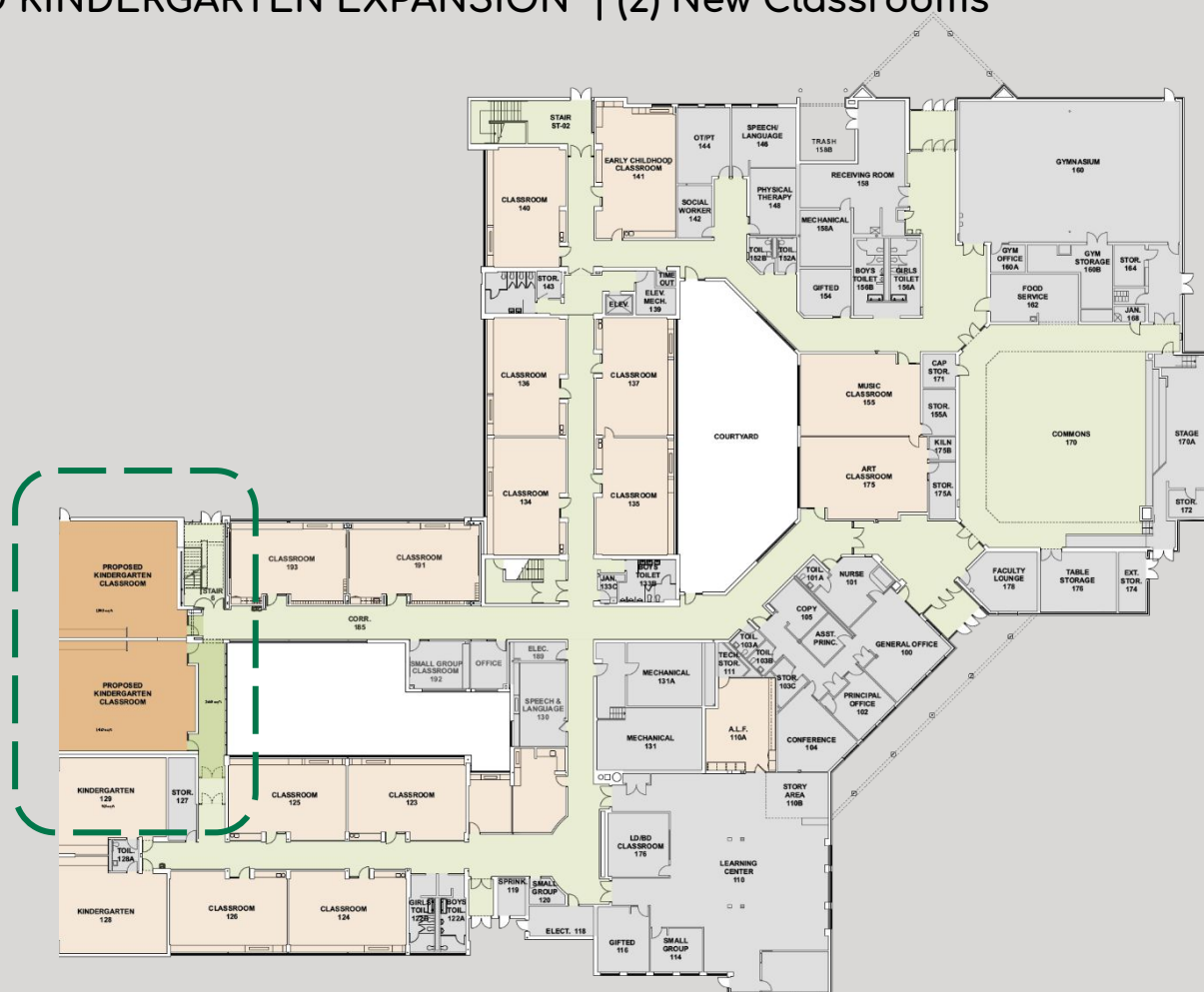



Ivy Hill Elementary School

2211 N. Burke Drive | Arlington Heights, IL 60004



SCOTT KAESE, PRINCIPAL | YEAR OPENED: 1966 | CURRENT SQUARE FOOTAGE: 77,088

KINDERGARTEN	AGING BUILDING INFRASTRUCTURE	CAPACITY AND LEARNING ENVIRONMENTS
<ul style="list-style-type: none">(0) New classrooms	<ul style="list-style-type: none">Remove remaining galvanized plumbing piping. Update restroom finishes.HVAC Boiler replacementsHVAC Air Handler replacementRoof replacementsNew energy efficient LED lighting and ceilings throughoutFlooring replacements	<ul style="list-style-type: none">New wall to provide separate quiet learning spaces in existing LMCBuilding has adequate buffer space for current and future needs



Ivy Hill Elementary School
2211 N. Burke Drive | Arlington Heights, IL 60004



NO EXPANSION PROPOSED

PROPOSED KINDERGARTEN EXPANSION | (0) New Classrooms

SCOTT KAESE, PRINCIPAL | YEAR OPENED: 1966 | CURRENT SQUARE FOOTAGE: 77,088



Olive-Mary Stitt Elementary School

303 E. Olive Street | Arlington Heights, IL 60004



ERIN DAVIS, PRINCIPAL | YEAR OPENED: 1962 | CURRENT SQUARE FOOTAGE: 83,293

KINDERGARTEN	AGING BUILDING INFRASTRUCTURE	CAPACITY AND LEARNING ENVIRONMENTS
<ul style="list-style-type: none">(4) New classrooms	<ul style="list-style-type: none">HVAC Building Automation System (BAS) upgrades.Masonry tuckpointing select locationsFlooring replacements	<ul style="list-style-type: none">Kindergarten addition gives building additional buffer space for current and future needs



Olive-Mary Stitt Elementary School

303 E. Olive Street | Arlington Heights, IL 60004



PROPOSED KINDERGARTEN EXPANSION | (4) New Classrooms





Patton Elementary School

1616 N. Patton Avenue | Arlington Heights, IL 60004



ERIC LARSON, PRINCIPAL | YEAR OPENED: 1962 | CURRENT SQUARE FOOTAGE: 54,934

KINDERGARTEN	AGING BUILDING INFRASTRUCTURE	CAPACITY AND LEARNING ENVIRONMENTS
<ul style="list-style-type: none">(3) New classrooms	<ul style="list-style-type: none">HVAC Building Automation System (BAS) upgrades.Parking lot replacementsReplace exterior stucco system due to water and bird damage.Replace water heaterUpgrade classroom door systems due to age and condition.Flooring replacements	<ul style="list-style-type: none">Kindergarten addition gives building additional buffer space for current and future needs



Patton Elementary School

1616 N. Patton Avenue | Arlington Heights, IL 60004



PROPOSED KINDERGARTEN EXPANSION | (3) New Classrooms

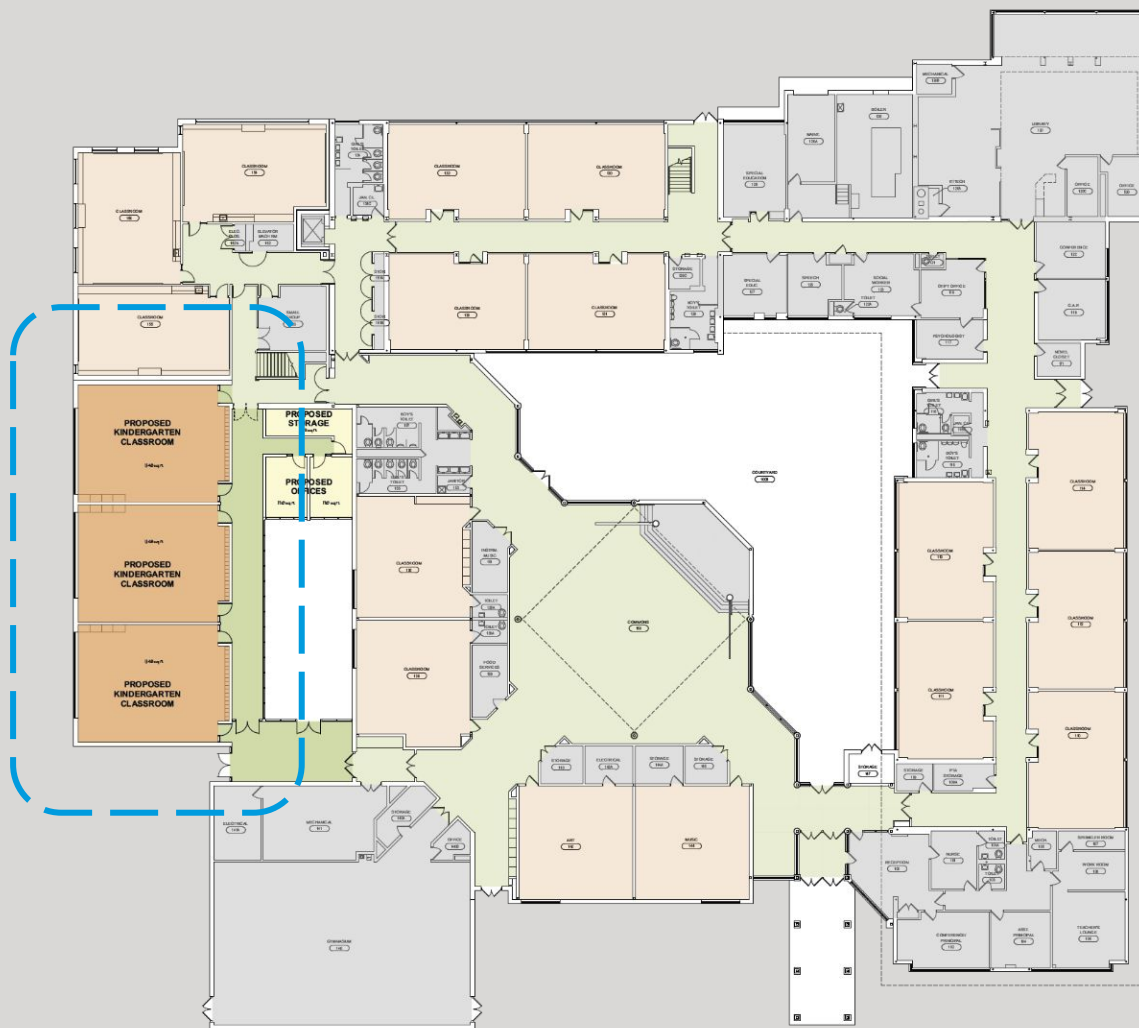



South Middle School

400 S. Highland Avenue | Arlington Heights, IL 60005



DR. JIM MORRISON, PRINCIPAL | YEAR OPENED: 1997 | CURRENT SQUARE FOOTAGE: 146,013

KINDERGARTEN

- No kindergarten scope

AGING BUILDING INFRASTRUCTURE

- Fire alarm system upgrades
- HVAC Building Automation System (BAS) upgrades
- Classroom HVAC unit-ventilator replacements
- Masonry tuckpointing and exterior envelope repairs
- East parking lot replacement
- Replace lunch table systems
- Corridor flooring replacements

CAPACITY AND LEARNING ENVIRONMENTS



Thomas Middle School

1430 N. Belmont Avenue | Arlington Heights, IL 60004



LORI NAUMOWICZ, PRINCIPAL | YEAR OPENED: 1964 | CURRENT SQUARE FOOTAGE: 144,270

KINDERGARTEN	AGING BUILDING INFRASTRUCTURE	CAPACITY AND LEARNING ENVIRONMENTS
<ul style="list-style-type: none">No kindergarten scope	<ul style="list-style-type: none">HVAC Boiler replacementsHVAC Building Automation System (BAS) upgradesReplace lunch table systemsNew energy efficient LED lighting in select locationsFlooring replacements	



Westgate Elementary School

500 S. Dwyer Avenue | Arlington Heights, IL 60005



ANN BUCH, PRINCIPAL | YEAR OPENED: 1957 | CURRENT SQUARE FOOTAGE: 74,000

KINDERGARTEN	AGING BUILDING INFRASTRUCTURE	CAPACITY AND LEARNING ENVIRONMENTS
<ul style="list-style-type: none">(10) New classrooms	<ul style="list-style-type: none">Major renovations throughout the schoolGalvanized plumbing piping removal and restrooms upgradesHVAC Air Handler replacementsHVAC Building Automation System (BAS) upgradesRoof replacementsWindow replacements and repairsNew energy efficient LED lighting and ceilings throughoutNew corridor flooring	<ul style="list-style-type: none">Gym expansion due to building enrollment + air conditioningKindergarten addition gives building additional buffer space for current and future needs



Westgate Elementary School

500 S. Dwyer Avenue | Arlington Heights, IL 60005



PROPOSED KINDERGARTEN EXPANSION | (10) New Classrooms + Gym Expansion w/ AC





Windsor Elementary School

1315 E. Miner Street | Arlington Heights, IL 60005



LINDSAY ANASTACIO, PRINCIPAL | YEAR OPENED: 1959 | CURRENT SQUARE FOOTAGE: 80,602

KINDERGARTEN	AGING BUILDING INFRASTRUCTURE	CAPACITY AND LEARNING ENVIRONMENTS
<ul style="list-style-type: none">(2) New classrooms	<ul style="list-style-type: none">HVAC Building Automation System (BAS) upgradesReplace exterior stucco system due to water and bird damage.New energy efficient LED lighting and ceilings throughoutCorridor flooring replacements	<ul style="list-style-type: none">Kindergarten addition gives building additional buffer space for current and future needs



LINDSAY ANASTACIO, PRINCIPAL | YEAR OPENED: 1959 | CURRENT SQUARE FOOTAGE: 80,602



DUNTON ADMINISTRATION

- Remove remaining galvanized plumbing piping. Update restroom finishes.
- Main electrical panel upgrades
- West parking lot replacement
- HVAC fan coil unit replacement in select locations
- Security camera upgrades

MINER SCHOOL

- Phased exterior window system replacement
- HVAC outside air improvements
- HVAC unit ventilator replacements
- HVAC new Building Automation System (BAS)
- Select galvanized piping replacement projects

RAND SCHOOL

- Galvanized plumbing piping and restrooms upgrades
- HVAC phased classroom unit ventilator replacement
- Fire alarm system replacement
- Exterior masonry repairs
- Phased north roofing replacement
- Wooden bleacher replacement